

DUNAVOX
THE WINE COOLING EXPERT

Sera



Champagne & Prosecco

A VISION OF GLOBAL REACH

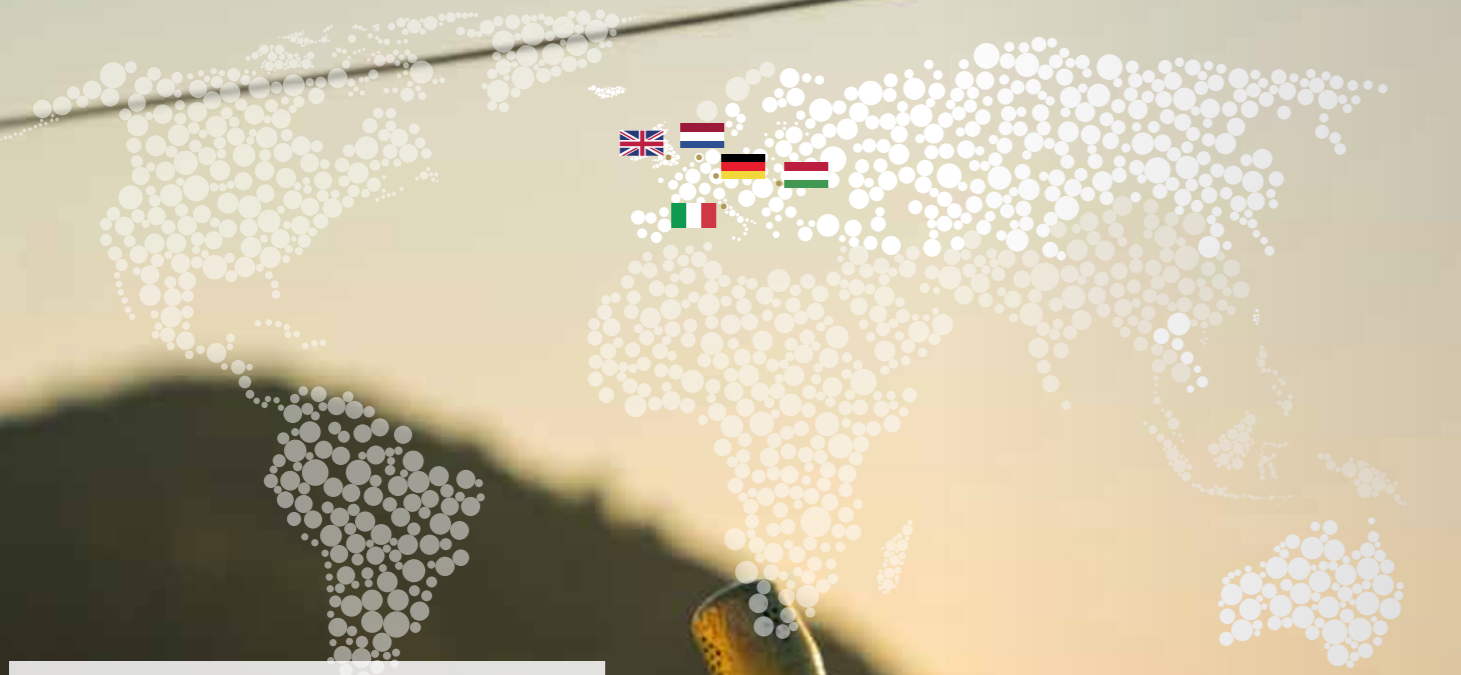

MORE THAN
40
COUNTRIES AROUND THE WORLD

MORE THAN
100
MODELS

For almost twenty years, the award winning wine cooler brand, Dunavox, has been associated with professional storage and cooling solutions for wine at home – Dunavox has been at the forefront of development and is known for minimalistic yet functional design character, practical internal layout, state-of-the art technology and energy efficiency. As a result of recent further business expansion, Europe's largest range of over 100 premium wine coolers is now available through its network of global distributors but also five separate Dunavox subsidiaries – all providing high quality assistance, technical support and after-sales service.



THE BIRTH OF THE SERA RANGE



Within the wine cooler industry there is a common problem in that larger bottles such as prosecco and champagne can't usually be accommodated without removal of shelves, aesthetically this is not the best option and will also reduce the capacity of the wine cooler – this led to the Sera range being born.

Dunavox has designed and is producing a range of wine coolers designed for the larger bottle that not only accommodates the larger style bottles but also displays them in a way that no other wine cooler does.

Champagne and sparkling wines are seen as premium beverages in the wine world which is why Dunavox ensured the Sera range is as luxurious as possible, quiet and energy efficient. With the option to change the lighting colours from; white, blue or amber you have the option to cater the aesthetic to the design of your room.

The new Sera range from Dunavox is available in three sizes and single or dual zone models, not to mention a full glass door or with seamless stainless steel option as well – show your wines off in style, with the new range of champagne fridges from Dunavox.

“COME QUICKLY, I AM TASTING THE STARS!”
- DOM PERIGNON



The sparkling version of the Champagne wine was discovered by accident. It all began when the wine growers (today's famous Champagne Houses) from the Champagne region were trying to equal the Burgundy wines. However, they did not succeed due to the cold winters in the region that caused the fermentation of the wine which were lying in the cellars, to stop. The cold climate ensured that the sleeping yeast cells awoke again in spring and started fermenting causing the release of carbon dioxide gas, which was coming from the wine in the bottle. At first, the bottles were weak and exploded but the ones that survived contained the sparkling wine. Champagne is a special drink, it has been associated with royalty since the 17th century and brings a different vibe to any gathering or event. Making champagne requires patience and certain processes to bring the ideal taste out of the grapes, the sparkle comes from the second fermentation process which is unique to sparkling wines and takes place inside the bottle. At Dunavox, we are joining the sparkling wine revolution and expanding our range for the joy of Champagne lovers!



SPECIAL STORAGE REQUIREMENTS

Dunavox wine coolers are designed to mimic a wine cellar, the features that occur naturally in a wine cellar are all managed and maintained within a Dunavox wine cooler. There is a balance of light, temperature and humidity, where your champagne collection can be stored in peace. Wine cellars are difficult to incorporate into existing houses and are generally found in the basement, this means that a Dunavox wine cooler is the perfect solution to store all your wines safely and for many years to come.



VIBRATION FREE STORING

The compressor is the heart of every champagne cooler. The compressor is fixed on 4 strong rubber bushes, to minimize the vibration during operation. The champagne will not be affected by compressor start/stop cycles.



UV LIGHT PROTECTION

A special layer included on the door which reduces the harmful effects of UV lights. Direct sunlight is still harmful for the unit and the wines. Please consider this when installing the champagne cooler.

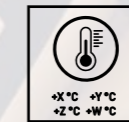

TEMPERATURES

Cooling range can be set between X°C to Y°C in the upper zone, and Z°C to W°C in the lower zone.



HUMIDITY CONTROL

There is a plastic box on one of the shelves inside the unit. Filling it with water allows to increase the inner humidity in the cabinet.

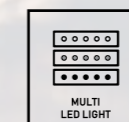

MULTI LED LIGHT

Interior LED light colour which can be set to white, blue and amber.



RACK DISTANCE

The optimal distance between the shelves fits comfortably with the champagne & prosecco bottles.



STANDARD BOTTLE

Bottle capacity and shelf distance is based on standard shaped champagne bottles, dimensions listed above.



DUNAVOX *Sera-40*

The DUNAVOX Sera-40 actively chills your favourite bottle of champagne or prosecco and keeps it cool and refreshing. Ideal for convenient storage of 40 champagne bottles. A single zone, undercounter model, boasting an elegant exterior and a stainless steel door handle. Bottles are supported on patent display shelves set into a stunning light white, amber and blue interior. Please note that this model is intended as a built in undercounter model. Cannot be used as a freestanding model.

[1] COOLING ZONE	HANDLE DOOR	MULTI LED LIGHT	UNDERCOUNTER	CHAMPAGNE & PROSECCO	FAN ASSISTED COOLING
HUMIDITY CONTROL	UV LIGHT PROTECTION	VIBRATION FREE STORING	TOUCH SCREEN	40 BOTTLES	+5°C +20°C
750 ml 310x85mm	130 LITRE	45 KG	41 dB	3 YEARS WARRANTY	

door	Reversible tinted glass door (UV treated)
shelves	Telescopic display shelves
lighting	White, amber and blue LED lighting
width	595 mm
height	813 mm
depth	570 mm

DAUF-40.138B

DAUF-40.138SS

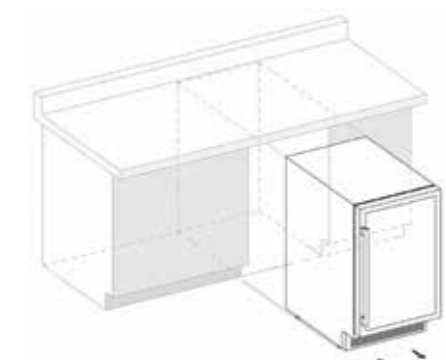

Technical support files



DUNAVOX *Sera-58*

The DUNAVOX Sera-58 actively chills your favourite bottle of champagne or prosecco and keeps it cool and refreshing. Ideal for convenient storage of 58 champagne bottles. A double zone, freestanding and integrated model, boasting an elegant exterior and a stainless steel door handle. Bottles are supported on patent display shelves set into a stunning light white, amber and blue interior. The top zone must be colder than the lower zone. Please note that this model is suitable for freestanding or built in use.

[2] COOLING ZONES	HANDLE DOOR	MULTI LED LIGHT	FREESTANDING	INTEGRATED	FAN ASSISTED COOLING
HUMIDITY CONTROL	UV LIGHT PROTECTION	VIBRATION FREE STORING	TOUCH SCREEN	58 BOTTLES	CHAMPAGNE & PROSECCO
750 ml 310x85mm	+5 °C +12 °C +12 °C +20 °C	258 LITRE	72 KG	38 dB	3 YEARS WARRANTY

door	Reversible tinted glass door (UV treated)
shelves	Telescopic display shelves
lighting	White, amber and blue two-side LED lighting
width	595 mm
height	1215 mm
depth	680 mm

DX-58.258DB

DX-58.258DSS

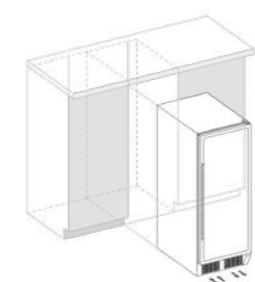

Technical support files



DUNAVOX *Sera-70*

The DUNAVOX Sera-70 actively chills your favourite bottle of champagne or prosecco and keeps it cool and refreshing. Ideal for convenient storage of 70 champagne bottles. A single zone, freestanding and integrated model, boasting an elegant exterior and a stainless steel door handle. Bottles are supported on patent display shelves set into a stunning light white, amber and blue interior. Please note that this model is suitable for freestanding or built in use.

[1] COOLING ZONE	HANDLE DOOR	MULTI LED LIGHT	FREESTANDING	INTEGRATED	FAN ASSISTED COOLING
HUMIDITY CONTROL	UV LIGHT PROTECTION	VIBRATION FREE STORING	TOUCH SCREEN	70 BOTTLES	CHAMPAGNE & PROSECCO
750 ml 310x85mm	+5 °C +20 °C	258 LITRE	72 KG	38 dB	3 YEARS WARRANTY

door	Reversible tinted glass door (UV treated)
shelves	Telescopic display shelves
lighting	White, amber and blue two-side LED lighting
width	595 mm
height	1200 mm
depth	680 mm

DX-70.258B

DX-70.258SS

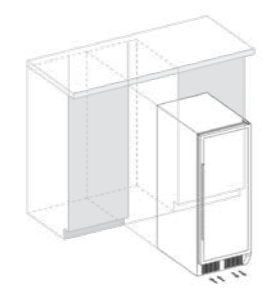

Technical support files



DUNAVOX *Sera-143*

The DUNAVOX Sera-143 actively chills your favourite bottle of champagne or prosecco and keeps it cool and refreshing. Ideal for convenient storage of 143 champagne bottles. A single zone, freestanding and integrated model, boasting an elegant exterior and a stainless steel door handle. Bottles are supported on patent display shelves set into a stunning light white, amber and blue interior. Please note that this model is suitable for freestanding or built in use.

[1] COOLING ZONE	HANDLE DOOR	MULTI LED LIGHT	FREESTANDING	INTEGRATED	FAN ASSISTED COOLING
HUMIDITY CONTROL	UV LIGHT PROTECTION	VIBRATION FREE STORING	TOUCH SCREEN	143 BOTTLES	CHAMPAGNE & PROSECCO
750 ml 310x85mm	+5 °C -20 °C	468 LITRE	108 KG	48 dB	3 YEARS WARRANTY

door	Lock, reversible tinted glass door (UV treated)
shelves	Telescopic display shelves
lighting	White, amber and blue LED lighting
width	655 mm
height	1835 mm
depth	680 mm

DX-143.468B



DX-143.468SS



Technical support files



www.dunavox.com

info@dunavox.com



www.facebook.com/dunavoxglobal



www.instagram.com/dunavoxglobal



www.linkedin.com/company/dunavox